



Kit piston D46 for

KTM ENDURO WP Xplor 2017-19

REBOUND SIDE
5X24X0.30
26X0.30
28X0.30
30X0.30
32X0.25
34X0.25
36X0.25
28X0.10
4X38X0.20

COMPRESSION SIDE
3X42X0.20
24X0.15
3X40X0.20
2X38X0.20
36X0.20
34X0.25
32X0.25
30X0.25
28X0.25
5X26X0.30

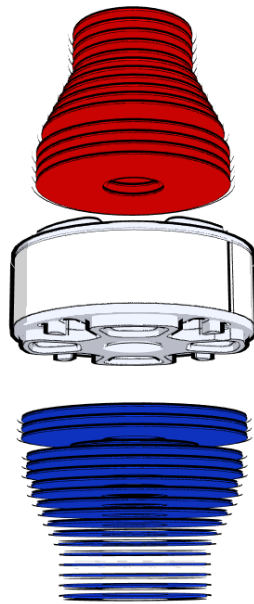

SUGGESTED SETTINGS
COMP. HIGHT SPEED: 2 TURN FROM CLOSE TO OPEN
COMP. LOW SPEED: 13 CLICK OPEN
REB.:12 CLICK OPEN
STATIC SAG: 38/40MM
DYNAMIC SAG:110/115MM
PRESSURE: 10Bar
OIL: SAE3W

For more information, please take a look at www.dalsoggiorace.com